

Neighborhood: Douglas

Proposed Zoning

-  CC2
-  LW1
-  Neighborhood Node
-  RM15
-  RS5

MAP DESCRIPTION:

This map shows parcels and their proposed zoning district. Parcels not shown on the map are not being considered for rezoning.

DISCLAIMER:

This map is a user-generated public output from a mapping software and is for reference only. Data layers on this map may or may not be accurate, current, or otherwise reliable. **THIS MAP IS NOT TO BE USED FOR NAVIGATION.** The changes shown on this map have not been finalized.

Learn about Proposed Updates to the

Zoning Code & Map



This project includes changes to commercial zoning districts & commercial development standards.

Review these changes at
www.imaginekalamazoo.com/projects/zoningupdates.

These changes are intended to:

- Update old or out-of-date standards, some which were created in 2005.
- Align the Zoning Code with Imagine Kalamazoo & the 2025 Master Plan.
- Support economic development & community investment through better written & streamlined rules.

Utilice este código QR para esta información en español.

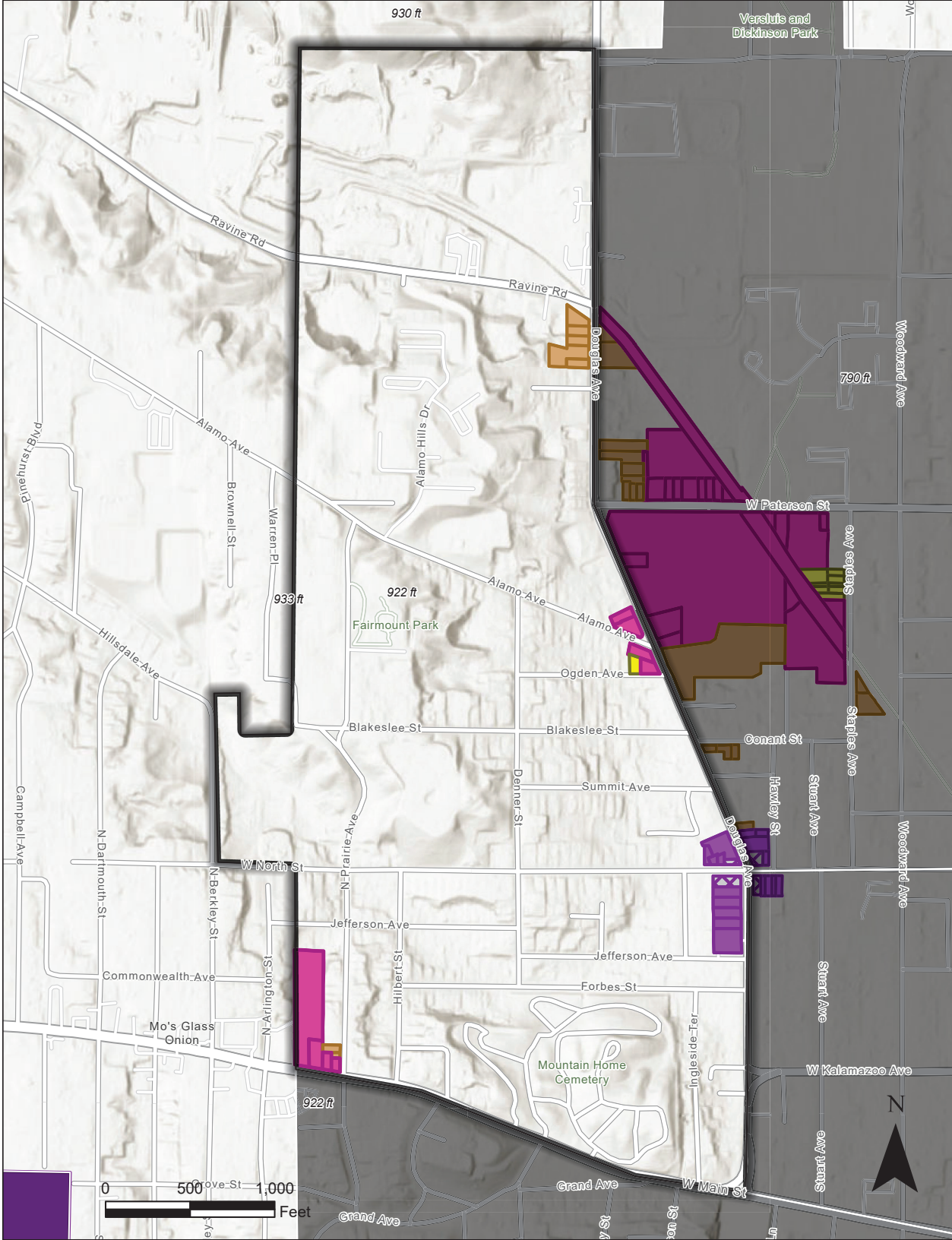

Street Name	Full Property Address	Existing Zone	Proposed Zone	Neighborhood
DOUGLAS	1511 DOUGLAS AVE	CN-1	RM15	Douglas
DOUGLAS	1507 DOUGLAS AVE	CN-1	RM15	Douglas
DOUGLAS	1503 DOUGLAS AVE	CN-1	RM15	Douglas
DOUGLAS	1437 DOUGLAS AVE	CN-1/M1	RM15	Douglas
DOUGLAS	1431 DOUGLAS AVE	CN-1	RM15	Douglas
DOUGLAS	1117 DOUGLAS AVE	CN-1	CC2	Douglas
DOUGLAS	1103 DOUGLAS AVE	CN-1	CC2	Douglas
DOUGLAS	1011 DOUGLAS AVE	CN-1	CC2	Douglas
DOUGLAS	1005 DOUGLAS AVE	CN-1	CC2	Douglas
DOUGLAS	701 DOUGLAS AVE	CC	Nhood Node	Douglas
DOUGLAS	619 DOUGLAS AVE	CO	Nhood Node	Douglas
DOUGLAS	617 DOUGLAS AVE	CO	LW1	Douglas
DOUGLAS	613 DOUGLAS AVE	CO	LW1	Douglas
DOUGLAS	605 DOUGLAS AVE	CO	LW1	Douglas
DOUGLAS	531 DOUGLAS AVE	CO	LW1	Douglas
DOUGLAS	527 DOUGLAS AVE	CO	LW1	Douglas
DOUGLAS	717 DOUGLAS AVE	CC	LW1	Douglas
MAIN	1624 W MAIN ST	CN-1	CC2	Douglas
MAIN	1614 W MAIN ST	CN-1	CC2	Douglas
MAIN	1610 W MAIN ST	CN-1	CC2	Douglas
MAIN	1604 W MAIN ST	CN-1	CC2	Douglas
MAIN	1120 W NORTH ST	CC/RM15	LW1	Douglas
MAIN	1110 W NORTH ST	CC	LW1	Douglas
NORTH	1114 W NORTH ST	CC	LW1	Douglas
OGDEN	1214 OGDEN AVE	CN-1	RS5	Douglas
PRAIRIE	313 PRAIRIE AVE	CN-1	RM15	Douglas
PRAIRIE	311 PRAIRIE AVE	CN-1	RM15	Douglas