

# Neighborhood: Parkview Hills

Neighborhood

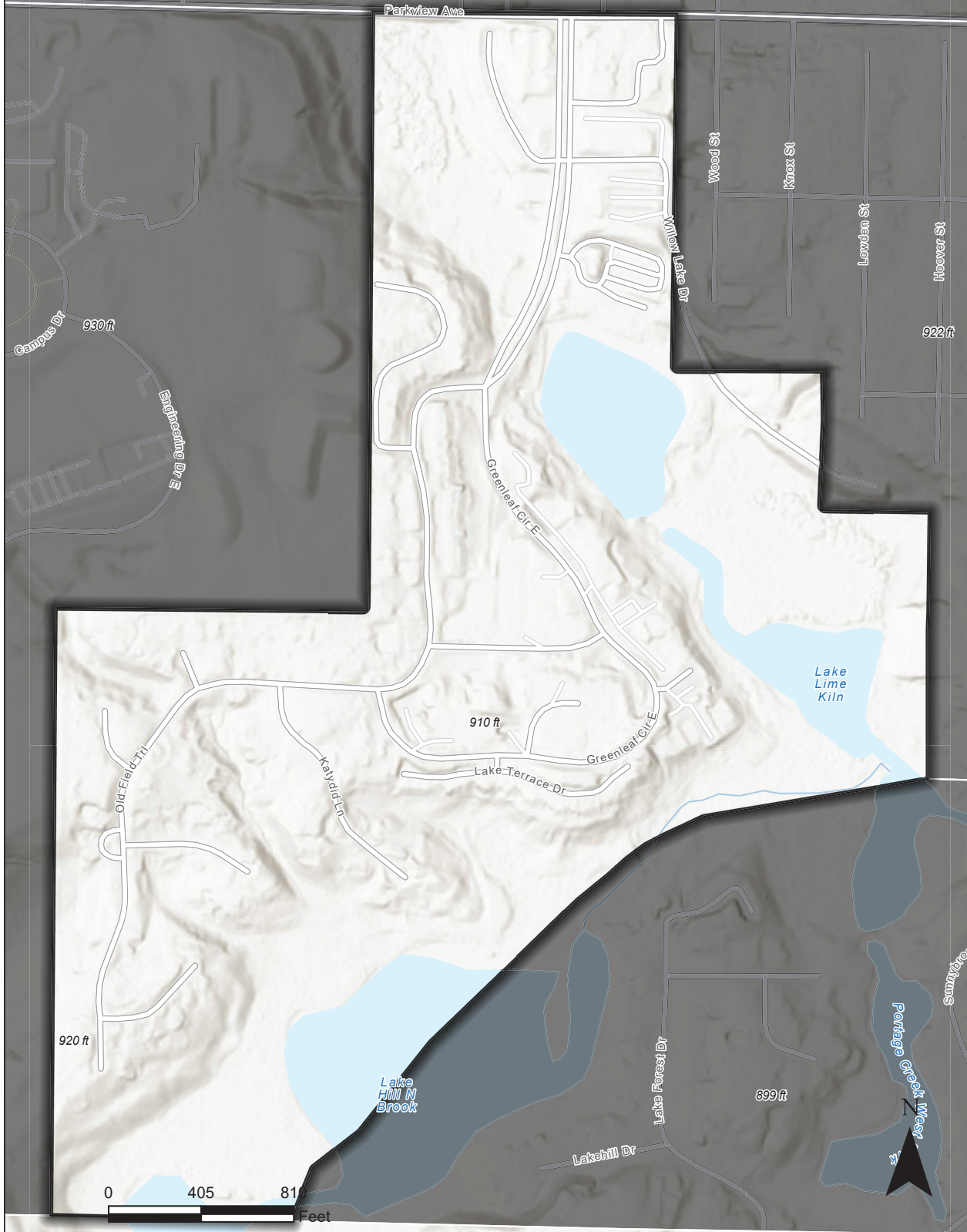

## MAP DESCRIPTION:

This map shows parcels and their proposed zoning district. Parcels not shown on the map are not being considered for rezoning.

## DISCLAIMER:

This map is a user-generated public output from a mapping software and is for reference only. Data layers on this map may or may not be accurate, current, or otherwise reliable. THIS MAP IS NOT TO BE USED FOR NAVIGATION. The changes shown on this map have not been finalized.

Learn about Proposed Updates to the

## Zoning Code & Map



This project includes changes to commercial zoning districts & commercial development standards.

Review these changes at  
[www.imaginekalamazoo.com/projects/zoningupdates](http://www.imaginekalamazoo.com/projects/zoningupdates).

These changes are intended to:

- Update old or out-of-date standards, some which were created in 2005.
- Align the Zoning Code with Imagine Kalamazoo & the 2025 Master Plan.
- Support economic development & community investment through better written & streamlined rules.

Utilice este código QR para esta información en español.

